

SIRCO UL

30 to 1200 A

(North American market)

- ▶ **Functions**
- ▶ **References**
- ▶ **Accessories**
- ▶ **Characteristics**
- ▶ **Dimensions**



ul_008_a



Functions

SIRCO UL are manually operated multipolar load-break switches. They break on and off under load and provide safety isolation for any low voltage circuit.

Conformity to standards

- UL 489 listed, Guide WJAZ, file E255272 for 30 A rating
- CSA 22.2 §5, Class 4652-06, file 112964
- UL 98 listed, Guide WHTY, file E201138 for 60 to 1200 A ratings
- CSA 22.2 §4, Class 4652-04, file 112964
- IEC 60947-3

General characteristics

- Fully visible breaking.
- High thermal and dynamic withstand.
- Arduous categories of applications.
- Good electrical and mechanical endurances.



ul_008_a

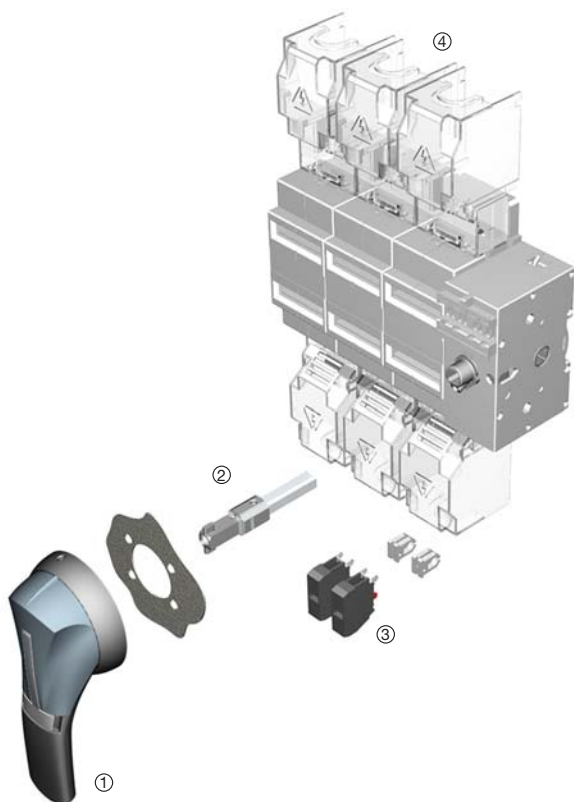

side_104_b_1_x_cut

Overview (for further details, please see the installation instructions supplied with each device).

1. External front handle
2. Shaft extensions for external handle
3. Configurable U type ACs, for pre-break and signalling or TEST
4. Terminal shrouds

T O O R D E R

DIRECT OPERATION	EXTERNAL OPERATION
<p>Switch body + Direct handle</p>	<p>Switch body + Shaft + External handle</p>
+ OTHER ACCESSORIES	

References

► Front operation SIRCO V

Rating (A)	No. of poles	Switch body only	Direct handle	Door interlocked external handle	Shaft extensions for external handle	NFPA 79 kit ⁽¹⁾	Auxiliary contacts	Terminal shrouds	Terminal lugs		
V 30	3 P	2700 3003	Black 3729 4012 Red 3729 4013	Black Selector (M) 4, 4X 2109 0U16 ⁽²⁾	320 mm 12.6 in Selector (M) 379M 0532	3729 4532	1 AC U type NO 3999 0701				
	3 P + switched neutral	2700 4003		Black Pistol (S) defeatable 1, 3R, 12 141F 2111 ⁽²⁾	320 mm 12.6 in Pistol (S) 1401 0532		1 AC U type NC 3999 0702				
V 60	3 P	2701 3006	3629 7910 ⁽⁵⁾			3729 7541	1 AC U type NO 3999 0701	3/4 pole integrated	3/4 pole integrated		
	4 P	2701 4006								3729 7541	1 AC U type NC 3999 0702
V 100	3 P	2701 3010				Black Pistol (S) defeatable 1, 3R, 12 142F 2111 ⁽²⁾	320 mm 12.6 in Pistol (S) 1400 1032	3729 7542	1 AC S type NC + NO 3999 U041		
	4 P	2701 4010								3729 7542	2 AC S type NC + NO 3999 U042
V 200	3 P	2701 3020				Black Pistol (S) defeatable 4, 4X 142D 2111 ⁽²⁾		3729 7542	1 AC S type NC + NO 3999 U041		
	4 P	2701 3020								3729 7542	2 AC S type NC + NO 3999 U042
V 400	3 P	2701 3039						3729 7542	1 AC S type NC + NO 3999 U041		
	4 P	2701 4039								3729 7542	2 AC S type NC + NO 3999 U042

(1) Includes mechanism, shaft and internal handle. Please order external handle.

(2) Nema type.

(3) Top supplied as standard.

(4) As replacement only as top and bottom shrouds are included.

(5) Not UL.

SIRCO UL

30 to 1200 A

(North American market)

Functions

References

Accessories

Characteristics

Dimensions

References

► Front operation SIRCO



Rating (A)	No. of poles	Switch body only	Direct handle	Door interlocked external handle	Shaft extensions for external handle	Auxiliary contact	Terminal screens	Terminal lugs																
400	3 P	2700 3040	3799 6012	Black 4, 4X defeatable Pistol (S) 143D 7111 ⁽¹⁾	200 mm 1401 1520	2699 U144 ⁽⁵⁾	3 P 2798 3060 ⁽²⁾	3 P 3954 6060 ⁽³⁾																
	4 P	2700 4040							4 P 2798 4060 ⁽²⁾	4 P 3954 8060 ⁽³⁾														
600	3 P	2700 3060					3799 6012	Black 4, 4X defeatable Pistol (S) 143D 7111 ⁽¹⁾			200 mm 1401 1520	2699 U144 ⁽⁵⁾	4 P 2798 4060 ⁽²⁾	4 P 3954 8060 ⁽³⁾										
	4 P	2700 4060							3 P 2798 3120 ⁽²⁾	3 P 3954 6120 ⁽⁴⁾														
800	3 P	2700 3080											3799 6012	Black 4, 4X defeatable Pistol (S) 143D 7111 ⁽¹⁾	200 mm 1401 1520	2699 U144 ⁽⁵⁾	4 P 2798 4120 ⁽²⁾	4 P 3954 8120 ⁽⁴⁾						
	4 P	2700 4080							3 P 2798 3120 ⁽²⁾	3 P 3954 6120 ⁽⁴⁾														
1000	3 P	2700 3100															3799 6012	Black 4, 4X defeatable Pistol (S) 143D 7111 ⁽¹⁾	200 mm 1401 1520	2699 U144 ⁽⁵⁾	4 P 2798 4120 ⁽²⁾	4 P 3954 8120 ⁽⁴⁾		
	4 P	2700 4100							3 P 2798 3120 ⁽²⁾	3 P 3954 6120 ⁽⁴⁾														
1200	3 P	2700 3120																			3799 6012	Black 4, 4X defeatable Pistol (S) 143D 7111 ⁽¹⁾	200 mm 1401 1520	2699 U144 ⁽⁵⁾
	4 P	2700 4120							3 P 2798 3120 ⁽²⁾	3 P 3954 6120 ⁽⁴⁾														

(1) Nema type.

(2) Top supplied as standard. be ordered at the same time as the AC contact holder.

(3) 6 terminals for 3 pole - 8 terminals for 4 pole.

(4) 12 terminals for 3 pole - 16 terminals for 4 pole.

(5) 4 auxiliary contacts as standard.

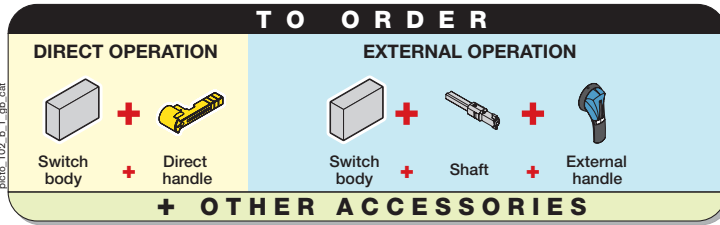

References

► Side operation SIRCO V



Rating (A)	No. of poles	Switch body only	Direct handle	"Flange" handle ⁽¹⁾	Cable for "Flange" handle ⁽¹⁾	Rod for "Flange" handle ⁽¹⁾	Auxiliary contacts	Terminal shrouds	Terminal lugs					
V 60	3 P	2705 3006	Black 3729 7901				1 AC S type NC + NO 3999 U041	3/4 pole integrated	3/4 pole integrated					
	4 P	2705 4006												
V 100	3 P	2705 3010						Standard handle 1, 3, 3R, 4, 12 defeatable 3729 9002 ⁽²⁾	Mechanism for "Flange" handle 3729 9902	900 mm 36 Inches 3729 9992	For enclosure depth of 6 Inches minimum 3729 9940	2 AC S type NC + NO 3999 U041	3798 3020 ⁽³⁾	3954 6020 ⁽⁵⁾
	4 P	2705 4010												
V 200	3 P	2705 3020						Chrome-plated handle 1, 3, 3R, 4, 4x, 12 defeatable 3729 9003 ⁽²⁾	1500 mm 60 Inches 3729 9993	3000 mm 120 Inches 3729 9994	For enclosure depth from 8 to 24 Inches 3729 9500		3798 4020 ⁽³⁾	3954 8020 ⁽⁵⁾
	4 P	2705 4020												
V 400	3 P	2705 3039											2798 3039 ⁽⁴⁾	3954 6060 ⁽⁵⁾
	4 P	2705 4039												

(1) NFPA 79 compliant accessories, see page A.278.
 (2) Nema type.
 (3) Top supplied as standard.
 (4) As replacement only as shrouds are included.
 (5) 6 terminals for 3 poles - 8 terminals for 4 poles.

SIRCO UL

30 to 1200 A

(North American market)

- Functions
- References
- ▶ **Accessories**
- Characteristics
- Dimensions

NFPA 79 compliant accessories

“Flange” handle for side operated SIRCO V

sirco_246_a_1_cat



Use
For side operated switches only provides heavy duty flange style operation. Meets both UL508A and NFPA 79 requirement. Please order cable or rod link between handle and switch.

Rating (A)	Handle type	Nema type	References
V 60 ... V 400	standard handle	1, 3, 3R, 4, 12	3729 9002 ⁽¹⁾
V 60 ... V 400	chrome-plated handle	1, 3, 3R, 4, 4X, 12	3729 9003 ⁽¹⁾

(1) Defeatable.

Cables for “Flange” handle for side operated SIRCO V

sirco_247_a_1_cat



Use
Link between “Flange” handle and side operated switches, please order mechanism and “Flange” handle.

Rating (A)	Type	Reference
V 60 ... V 400	mechanism for “Flange” handle	3729 9902

Cable length (inches)	Cable length (mm)	References
36	900	3729 9992
60	1500	3729 9993
120	3000	3729 9994

ul_042_b_1



Rod for “Flange” handle for side operated SIRCO V

ul_043_a



Use
Link between “Flange” handle and side operated switches. Mechanism included, cost effective solution. Please order “Flange” handle.

For enclosure depth (inches)	For enclosure depth (mm)	References
6	150	3729 9940
8 ... 24	203 ... 613	3729 9500

NFPA 79 kit for front operated SIRCO V

ul_121_b



Use
For front operated switches only. Meets both UL508A and NFPA 79 requirement. Kit includes mechanism, shaft and internal handle. Please order external handle (see page A.279).

Rating (A)	References
V 30	3729 4532
V 60 ... V 100	3729 7541
V 200 ... V 400	3729 7542

Accessories

Direct handle

For dimensions, see page A.288.



Fig. 1



Fig. 2



Fig. 3



Fig. 4

References

Front operation

Rating (A)	Handle colour	Fig.	References
V 30	Black	1	3729 4012
V 30	Red	1	3729 4013
V 60 ... V 400	Black	2	3629 7910⁽¹⁾
400 ... 1200	Black	4	3799 6012

(1) Not UL

Side operation

Rating (A)	Handle colour	Fig.	References
V 60 ... V 400	Black	3	3729 7901

Door interlocked external handle



M type handle



S1 type handle



S2 type handle



S3 type handle

Use

The door interlocked external handle include one lockable handle, one escutcheon and must be associated with a shaft extension.

For dimensions, see page A.289.

References

Front operation

Rating (A)	Handle type	Handle colour	Nema type	Defeatable ⁽¹⁾	References
V 30	M	Black	4, 4X	no	2109 0016
V 30	M	Red	4, 4X	no	2109 0015
V 30	S1	Black	1, 3R, 12	yes	141F 2111
V 30	S1	Red	1, 3R, 12	yes	141G 2111
V 30	S1	Black	4, 4X	yes	141D 2111
V 30	S1	Red	4, 4X	yes	141E 2111
V 60 ... V 400	S2	Black	1, 3R, 12	yes	142F 2111
V 60 ... V 400	S2	Red	1, 3R, 12	yes	142G 2111
V 60 ... V 400	S2	Black	4, 4X	yes	142D 2111
V 60 ... V 400	S2	Red	4, 4X	yes	142E 2111
400 ... 1200	S3	Black	4, 4X	no	143D 7111
400 ... 1200	S3	Black	4, 4X	yes	143D 3111
400 ... 1200	S3	Red	4, 4X	no	143E 7111
400 ... 1200	S3	Red	4, 4X	yes	143E 3111

(1) Allow the door to be opened when the switch is on 1 (ON) position.

SIRCO UL

30 to 1200 A

(North American market)

- Functions
- References
- ▶ **Accessories**
- Characteristics
- Dimensions

Accessories

Shaft extensions for external front handle



access_143_a_1_cat

Use

Standard length:
 - 120 mm,
 - 200 mm,
 - 320 mm,
 - 400 mm.
 Other lengths: please consult us.

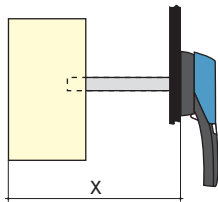

access_202_a

References

Rating (A)	Handle type	Shaft length (in/mm)	References
V 30	M	4.7 / 120	379M 0512
V 30	M	7.9 / 200	379M 0520
V 30	M	12.6 / 320	379M 0532
V 30	M	15.7 / 400	379M 0540
V 30	S1	7.9 / 200	1401 0520
V 30	S1	12.6 / 320	1401 0532
V 30	S1	15.7 / 400	1401 0540
V 60 ... V 400	S2	7.9 / 200	1400 1020
V 60 ... V 400	S2	12.6 / 320	1400 1032
V 60 ... V 400	S2	15.7 / 400	1400 1040
400 ... 1200	S3	7.9 / 200	1401 1520
400 ... 1200	S3	15.7 / 400	1401 1540

X minimum dimension

Rating (A)	Handle type M		Handle type S	
	in	mm	in	mm
V 30	4.14	105	5.31	135
V 60 ... V 100	-	-	5.31	135
V 200	-	-	7.32	186
V 400	-	-	11.30	287
400 ... 1200	-	-	11.30	287

Snap-on U type pre-break auxiliary contacts for front operation



access_045_a_1_cat

Use

For ratings from SIRCO V 30 to 100 A, up to 4 ACs max.
 From SIRCO V 200 to 400 A, up to 8 ACs max.
 Up to 1200 A, please consult us.

Connection to the control circuit

By terminal with a section of 2 x 2,5 mm² max.

References

<i>NO auxiliary contact</i>		
Rating (A)	No. of AC	Reference
V 30 ... V 400	1	3999 0701
<i>NC auxiliary contact</i>		
Rating (A)	No. of AC	Reference
V 30 ... V 400	1	3999 0702
<i>NO/NC auxiliary contact</i>		
Rating (A)		Reference
400 ... 1200		2699 U144 ⁽¹⁾

(1) 4 auxiliary contacts included a standard.

S type auxiliary contacts for SIRCO V only



access_051_a_3_cat

Use

Position 0 and I signalling by 1 to 4 auxiliary contacts NO + NC.
 Installation on the side of the switch with a maximum of two blocks.
 High electrical characteristics.

Connection

By cage with a section of 10 mm².

References

<i>NC + NO auxiliary contacts</i>		
Rating (A)	No. of AC	References
V 60 ... V 400	1	3999 U041
V 60 ... V 400	2	3999 U042

Accessories

Terminal shrouds or terminal screens

sirco_069_a_1_cat



fusion_069_a_1_cat



Use

Top and bottom protection against direct contacts with terminals or connection parts.

References

Rating (A)	No. of poles	Type	References
V 30 ... V 100	3/4 P		integrated
V 200	3 P	terminal shrouds	3798 3020 ⁽¹⁾
V 200	4 P	terminal shrouds	3798 4020 ⁽¹⁾
V 400	3 P	terminal shrouds	2798 3039 ⁽²⁾
V 400	4 P	terminal shrouds	2798 4039 ⁽²⁾
400 ... 600	3 P	terminal screens	2798 3060 ⁽¹⁾
400 ... 600	4 P	terminal screens	2798 4060 ⁽¹⁾
800 ... 1200	3 P	terminal screens	2798 3120 ⁽¹⁾
800 ... 1200	4 P	terminal screens	2798 4120 ⁽¹⁾

(1) Top supplied as standard.

(2) Top and bottom supplied as standard, for replacement only.

Top and bottom terminal lugs

ul_082_a



Use

Connection of copper cables on to the terminals (no spade lugs).

For dimensions, see page A.289.

References

Max. rating (A)	No. of poles	No. cable per lugs	Cable type	References
V 30 ... V 100	3/4 P	1	Cu	integrated
V 200	3 P	1	Cu	3954 6020 ⁽¹⁾
V 200	4 P	1	Cu	3954 8020 ⁽¹⁾
V 400	3 P	2	Cu	3954 6060 ⁽¹⁾
V 400	4 P	2	Cu	3954 8060 ⁽¹⁾
400 ... 600	3 P	2	Cu	3954 6060 ⁽¹⁾
400 ... 600	4 P	2	Cu	3954 8060 ⁽¹⁾
800 ... 1200	3 P	2	Cu	3954 6120 ⁽²⁾
800 ... 1200	4 P	2	Cu	3954 8120 ⁽²⁾

(1) 6 lugs for 3 pole - 8 lugs pole.

(2) 12 lugs for 3 pole - 16 lugs for 4 pole.

SIRCO UL

30 to 1200 A

(North American market)

UL and CSA characteristics for SIRCO V

Technical characteristics	V 30 A	V 60 A	V 100 A	V 200 A	V 400 A
Operating voltage	600	600	600	600	600
Short-circuit rating at 600 VAC (kA)	65	200	200	200	200
Fuse type	J or CC	J	J	J	J
Max. fuse rating (A)	30	60	100	200	400

Max. horsepower rating / Max. motor FLA current 3 ph

220-240 VAC	7.5 / 22	15 / 42	30 / 80	60 / 154	125 / 312
440-480 VAC	15 / 21	30 / 40	60 / 77	125 / 156	250 / 302
600 VAC	20 / 22	50 / 52	75 / 77	150 / 144	350 / 336
125 VDC	3 / 25 ⁽¹⁾	3 / 25 ⁽¹⁾	7.5 / 58 ⁽¹⁾	15 / 112 ⁽¹⁾	20 / 148 ⁽¹⁾
250 VDC	5 / 20 ⁽¹⁾	10 / 38 ⁽²⁾	20 / 72 ⁽²⁾	40 / 140 ⁽²⁾	50 / 173 ⁽²⁾

Mechanical characteristics

Endurance (number of operating cycles)	10 000	10 000	10 000	8 000	6 000
--	--------	--------	--------	-------	-------

Terminal lugs

Type	standard	standard	standard	option	option
Min. conn. section / AWG ⁽³⁾	#14	# 10	#10	#6	2 x 2
Max. conn. section / AWG ⁽³⁾	#10	# 3	#3	3 / 0	2 x 600 kcmil

(1) 2 pole in series.

(2) 3 pole in series.

(3) AWG: cross section of the American cable.

IEC 60947-1 and 60947-3 characteristics for SIRCO V

Technical characteristics	32 A	63 A	100 A	200 A	400 A
Rated insulation voltage U_i (V)	800	750	750	750	750
Rated impulse withstand voltage U_{imp} (kV)	8	8	8	8	8

Rated operation current I_e (A)

Rated voltage	Load duty category	A ⁽¹⁾	A ⁽¹⁾	A ⁽¹⁾	A ⁽¹⁾	A ⁽¹⁾
400 VAC	AC-22 A	32	63	100	200	400
	AC-23 A	32	63	100	200	400
690 VAC	AC-22 A	32	63	100	200	400
	AC-23 A	32	63	100	200	315

Operational power in AC-23 A (kW)⁽¹⁾⁽²⁾

At 400 VAC without pre-break AC	15	30	51	100	220
At 500 VAC without pre-break AC	18.5	40	63	140	220
At 690 VAC without pre-break AC	25	55	90	185	295

Conditional short-circuit current⁽³⁾

Rated peak withstand current (kA peak)	5.5	17.6	17.6	32	40
--	-----	------	------	----	----

Connection

Minimum Cu cable section (mm ²)	6	10	25	50	185
---	---	----	----	----	-----

(1) Category with index A = frequent operation.

(2) The power value is given for information only, the current values vary from one manufacturer to another.

(3) For a rated operating voltage $U_e = 400$ VAC.

UL and CSA characteristics for SIRCO

Technical characteristics	400 A	600 A	800 A	1000 A	1200 A
Operating voltage	600	600	600	600	600
Short-circuit rating at 600 VAC (kA)	200	200	100	100	100
Fuse type	J	J	L	L	L
Max. fuse rating (A)	400	600	800	1000	1200

Max. horsepower rating / Max. motor FLA current 3 ph

220-240 VAC	125 / 312	200 / 480	200 / 480	200 / 480	200 / 480
440-480 VAC	250 / 302	400 / 477	500 / 590	500 / 590	500 / 590
600 VAC	350 / 336	350 / 336	500 / 472	500 / 472	500 / 472
125 VDC	20 / 148 ⁽¹⁾	20 / 148 ⁽¹⁾	-	-	-
250 VDC	50 / 173 ⁽²⁾	50 / 173 ⁽²⁾	-	-	-

Mechanical characteristics

Endurance (number of operating cycles)	6 000	6 000	3 500	3 500	3 500
--	-------	-------	-------	-------	-------

Terminal lugs

Type	option	option	option	option	option
Min. conn. section / AWG ⁽³⁾	2 x 2	2 x 2	4 x 2	4 x 2	4 x 2
Max. conn. section / AWG ⁽³⁾	2 x 600 kcmil	2 x 600 kcmil	4 x 600 kcmil	4 x 600 kcmil	4 x 600 kcmil

(1) 2 pole in series.

(2) 3 pole in series.

(3) AWG: cross section of the American cable.

IEC 60947-1 and 60947-3 characteristics for SIRCO

Technical characteristics	400 A	600 A	800 A	1000 A	1250 A
Rated insulation voltage U_i (V)	1000	1000	1000	1000	1000
Rated impulse withstand voltage U_{imp} (kV)	12	12	12	12	12

Rated operation current I_e (A)

Rated voltage	Load duty category	A ⁽¹⁾	A ⁽¹⁾	A ⁽¹⁾	A ⁽¹⁾	A ⁽¹⁾
400 VAC	AC-22 A	400	630	800	1000	1200
	AC-23 A	400	630	800	1000	1000
690 VAC	AC-22 A	400	500	630	630	630
	AC-23 A	200	200	400	400	400

Operational power in AC-23 A (kW)⁽¹⁾⁽²⁾

At 400 VAC without pre-break AC	220	355	450	560	560
At 500 VAC without pre-break AC	280	450	560	560	560
At 690 VAC without pre-break AC	185	185	400	400	400

Conditional short-circuit current⁽³⁾

Rated peak withstand current (kA peak)	48	48	75	75	75
--	----	----	----	----	----

Connection

Minimum Cu cable section (mm ²)	185	2 x 150	2 x 185	2 x 240	-
Minimum Cu busbar section (mm ²)	-	2 x 30 x 5	2 x 40 x 5	2 x 50 x 5	2 x 60 x 5

(1) Category with index A = frequent operation.

(2) The power value is given for information only, the current values vary from one manufacturer to another.

(3) For a rated operating voltage $U_e = 400$ VAC.

SIRCO UL

30 to 1200 A

(North American market)

- Functions
- References
- Accessories
- Characteristics

► **Dimensions**

Dimensions

► **Front operation**

- SIRCO V UL 30 A

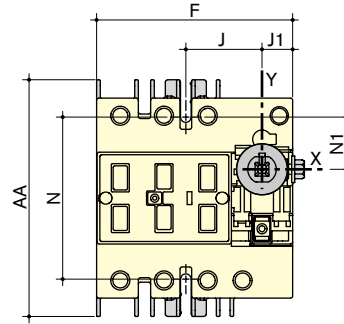
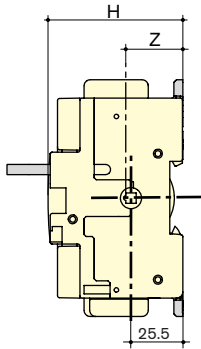

Switch body				Switch mounting				Connection terminals							
F		H		J		J1		N		N1		AA		Z	
in	mm	in	mm	in	mm	in	mm	in	mm	in	mm	in	mm	in	mm
3.78	96	2.59	66	1.47	37.5	0.59	15	3.13	79.5	1	25.5	4.56	116	1.12	28.5

- SIRCO V UL 60 and 100 A

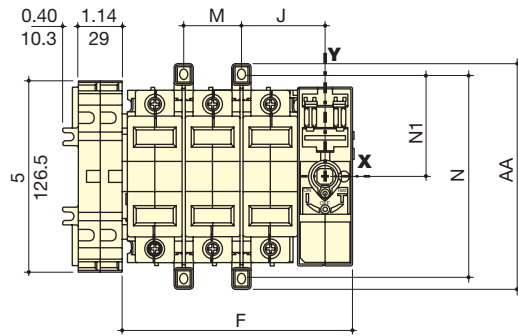
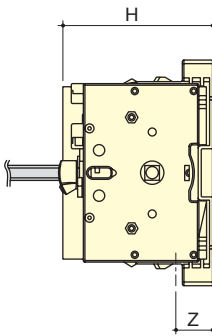

Switch body						Switch mounting						Connection terminals					
F 3p.		F 4p.		H		J		M		N		N1		AA		Z	
in	mm	in	mm	in	mm	in	mm	in	mm	in	mm	in	mm	in	mm	in	mm
5.98	152	7.48	190	3.89	99	2.12	54	1.5	38	5.25	133.5	2.63	66.5	5.87	149	0.95	24.5

Dimensions

► Front operation

• SIRCO V UL 200 A

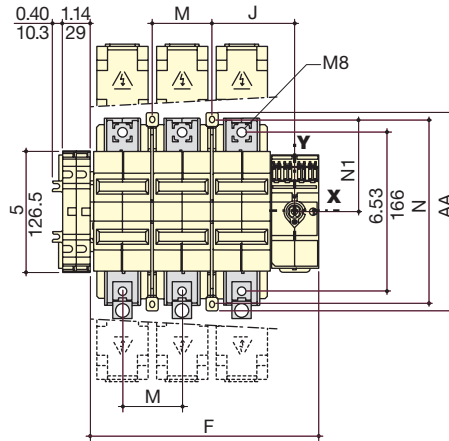
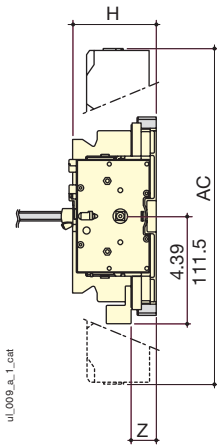

Terminal shrouds				Switch body				Switch mounting				Connection terminals							
AC		F 3p.		F 4p.		H		J		M		N		N1		AA		Z	
in	mm	in	mm	in	mm	in	mm	in	mm	in	mm	in	mm	in	mm	in	mm	in	mm
13.74	349	9.37	238	11.81	300	3.42	87	3.38	86	2.44	62	7.5	190.5	3.74	95	8.13	206.5	0.95	24.5

• SIRCO V UL 400 A

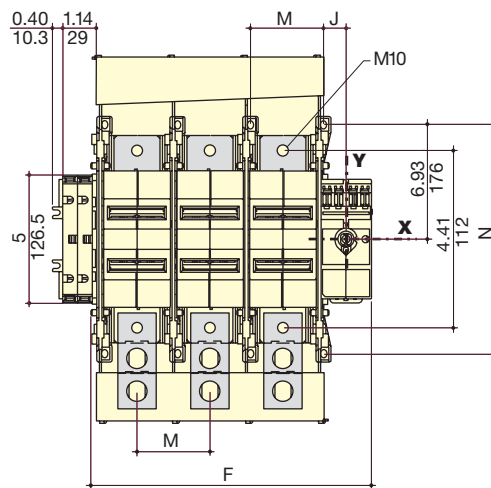
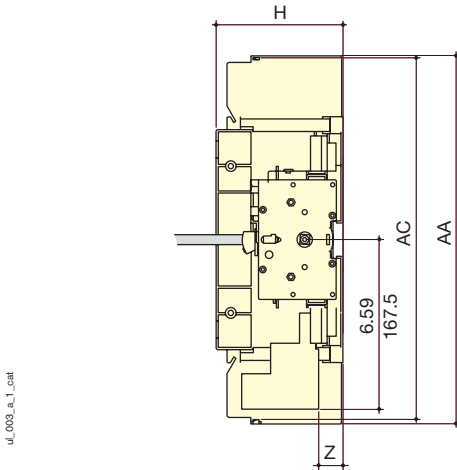

Terminal shrouds				Switch body				Switch mounting				Connection terminals					
AC		F 3p.		F 4p.		H		J		M		N		AA		Z	
in	mm	in	mm	in	mm	in	mm	in	mm	in	mm	in	mm	in	mm	in	mm
14.08	358	10.8	276	13.7	348	4.92	125	0.88	22.5	2.84	72	8.83	224	14.31	363.5	1.06	27

SIRCO UL

30 to 1200 A

(North American market)

- Functions
- References
- Accessories
- Characteristics
- Dimensions

Dimensions

► Front operation

• SIRCO UL 400 to 600 A

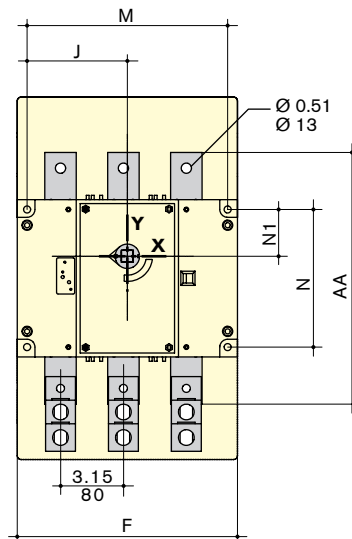
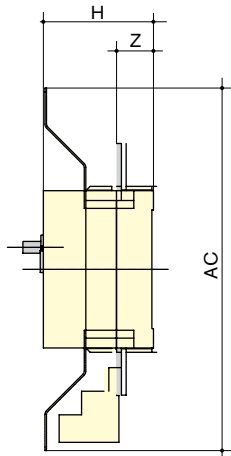

Terminal shrouds				Switch body					Switch mounting				Connection terminals										
AC		F 3p.		F 4p.		H		J 3p.		J 4p.		M 3p.		M 4p.		N		N1		AA		Z	
in	mm	in	mm	in	mm	in	mm	in	mm	in	mm	in	mm	in	mm	in	mm	in	mm	in	mm	in	mm
18.12	460	11	280	14.17	360	5.5	140	5	127.5	6.59	167.5	10.03	255	13.19	335	6.88	175	2.34	59.5	12.6	320	1.85	47

• SIRCO UL 800 to 1200 A

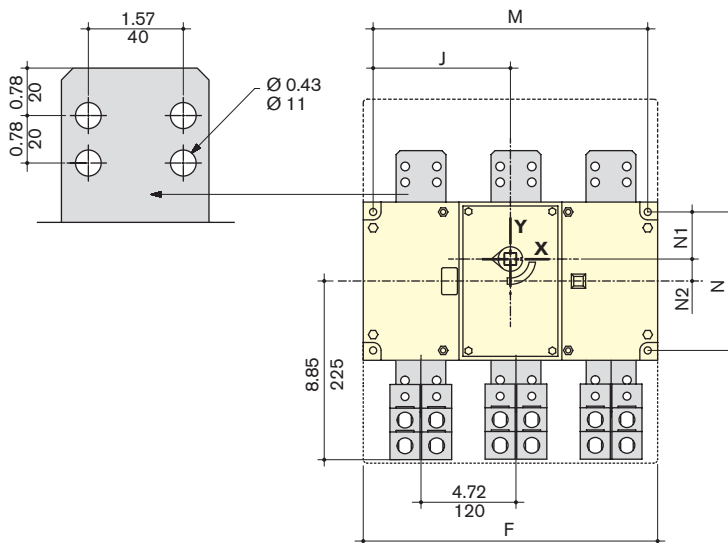
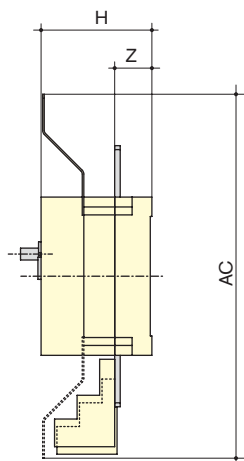

Terminal shrouds				Switch body					Switch mounting				Connection terminals										
AC		F 3p.		F 4p.		H		J 3p.		J 4p.		M 3p.		M 4p.		N		N1		N2		Z	
in	mm	in	mm	in	mm	in	mm	in	mm	in	mm	in	mm	in	mm	in	mm	in	mm	in	mm	in	mm
18.12	460	14.64	372	19.37	492	5.5	140	6.83	173.5	9.19	233.5	13.66	347	18.38	467	6.88	175	2.34	59.5	1.10	28	1.85	47

Dimensions

► Side operation

- SIRCO V UL 60 and 100 A

sirco_229_c_1_x_cat

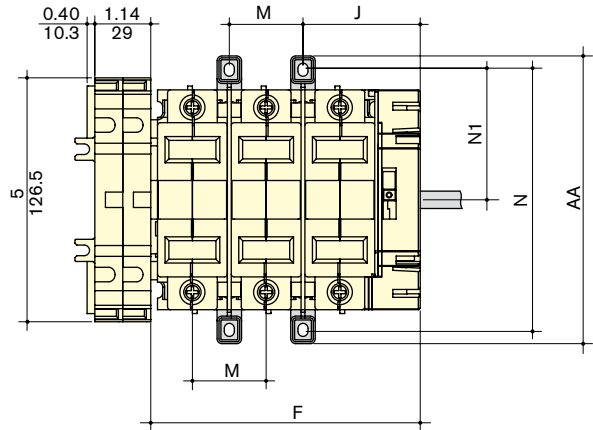
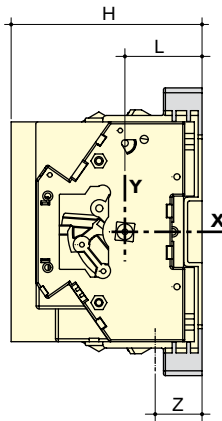

Rating (A)	Switch body				Switch mounting				Connection terminals											
	F 3p.		F 4p.		H		J		L		M		N		N1		AA		Z	
	in	mm	in	mm	in	mm	in	mm	in	mm	in	mm	in	mm	in	mm	in	mm	in	mm
60	5.45	138.5	6.95	176.5	3.89	99	2.32	59	1.57	40	1.49	38	5.25	133.5	2.62	66.5	5.86	149	0.96	24.5
100	7.09	180	9.13	232	3.89	99	2.32	59	1.47	37.5	1.49	38	5.25	133.5	2.62	66.5	5.86	149	0.96	24.5

- SIRCO V UL 200 A

sirco_230_b_1_x_cat

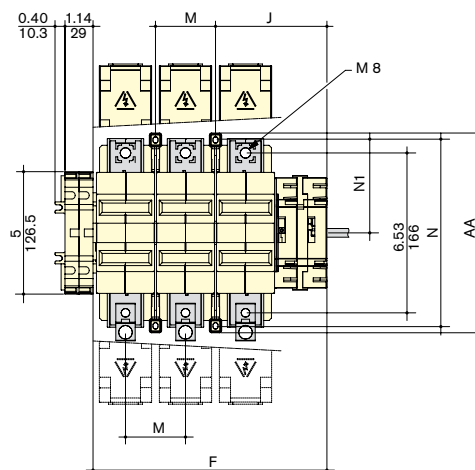
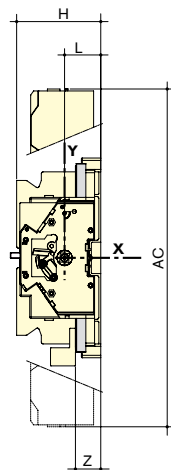

Terminal shrouds		Switch body				Switch mounting				Connection terminals											
AC		F 3p.		F 4p.		H		J		L		M		N		N1		AA		Z	
in	mm	in	mm	in	mm	in	mm	in	mm	in	mm	in	mm	in	mm	in	mm	in	mm	in	mm
13.74	349	9.47	240.5	11.9	302.5	3.42	87	4.47	113.5	1.47	37.5	2.44	62	7.5	190.5	3.74	95	8.13	206.5	0.96	24.5

SIRCO UL

30 to 1200 A

(North American market)

- Functions
- References
- Accessories
- Characteristics
- Dimensions

Dimensions

► Side operation

- SIRCO V UL 400 A

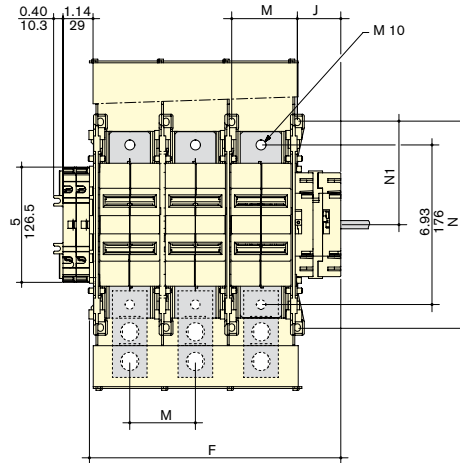
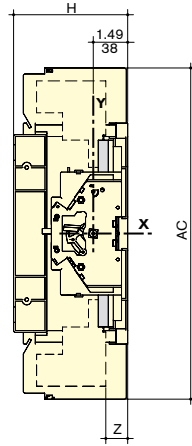

Terminal shrouds		Switch body		Switch mounting		Connection terminals													
AC	F 3p.	F 4p.	H	J	M	N	N1	AA	Z										
in	mm	in	mm	in	mm	in	mm	in	mm										
14.08	358	10.9	277	13.74	349	4.92	125	1.89	48	2.84	72	8.82	224	4.41	112	14.31	363.5	1.06	27

► Direct handle

Front operation

SIRCO V 30 A

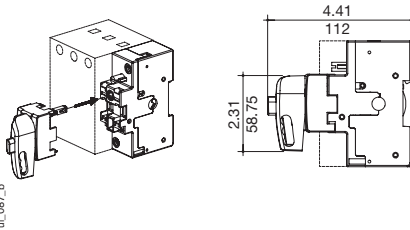

SIRCO 400 to 1200 A

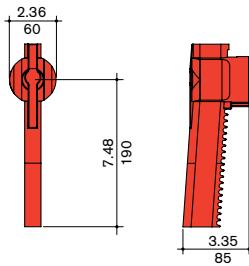

Side operation

SIRCO V 60 to 400 A

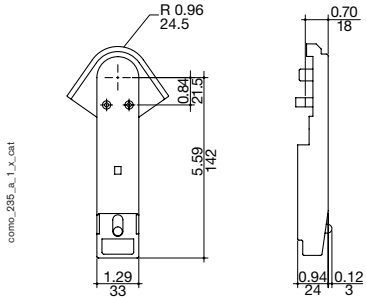

► "Flange" style handle

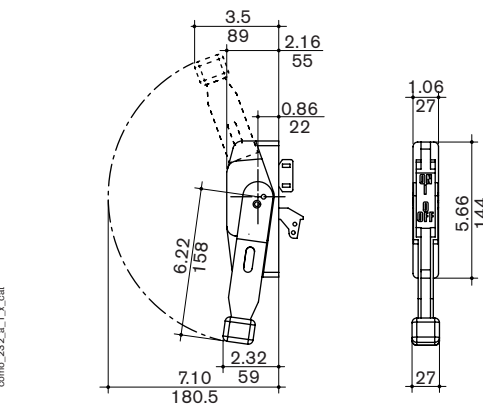

Dimensions

► Door interlocked external handle

S1 type handle

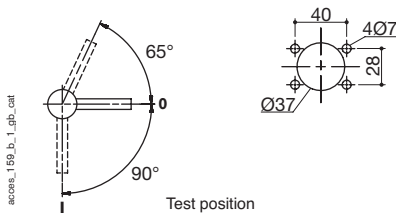
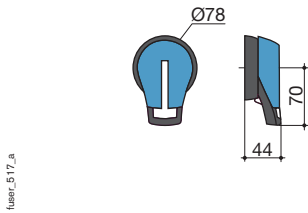

S2 type handle

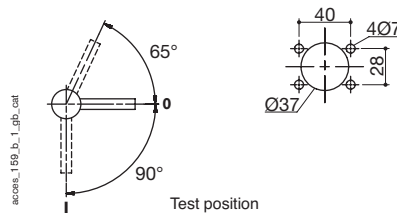
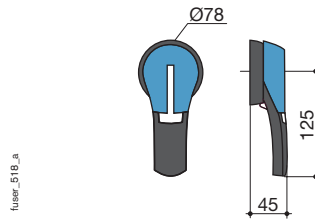

S3 type handle

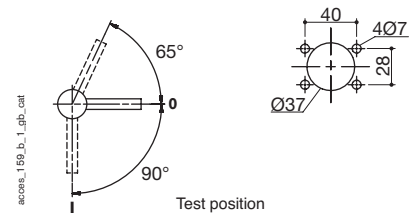
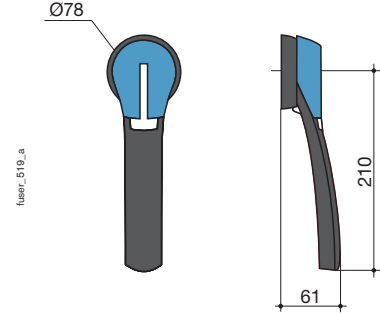

► Top and bottom terminal lugs

SIRCO V 200 A (6 or 8 lugs)

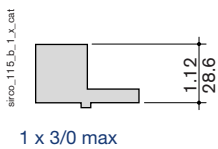
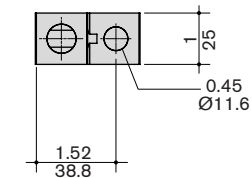

SIRCO V 400 and SIRCO 400 and 600 A (6 or 8 lugs)
SIRCO 800, 1000 and 1200 A (12 or 16 lugs)

